



INSTALLATION GUIDE

Clutch Cover Product
with replacement Brake Tip

Doc ID: 199-304A
Revision: 010518

OVERVIEW



- This kit replaces the OE (Original Equipment) or “stock” clutch cover, reusing the OE gasket. If the OE gasket is damaged it should be replaced to guarantee proper sealing.
- This kit also includes a replacement brake tip assembly, which is necessary to install to allow adequate clearance from the Rekluse clutch cover.

INSTALLATION TIPS

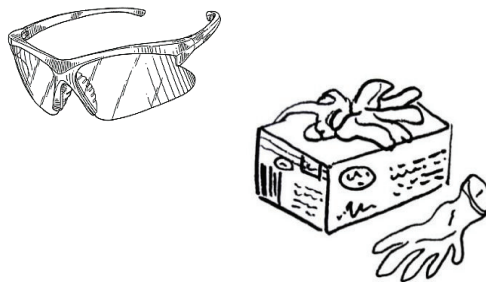
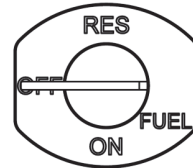
- Read this entire document before performing any steps.
- If you install this product for a customer or another person, instruct them to read all the provided documents before operating the bike with the product.
- Lay the motorcycle on its left side when working on the clutch. This makes clutch work easier and eliminates the need to drain the oil. Catch any fuel that may drain from the bike in a suitable container.
- Use the torque specifications found in your OE service manual.
- Use clean, quality oil with the JASO-MA or JASO-MA2 certification for motorcycles for best performance.
- Protect eyes and skin – wear safety glasses and work gloves.



TOOLS

	 4 mm	
8 mm socket	4 mm Hex key	Torque Wrench

INCLUDED PARTS

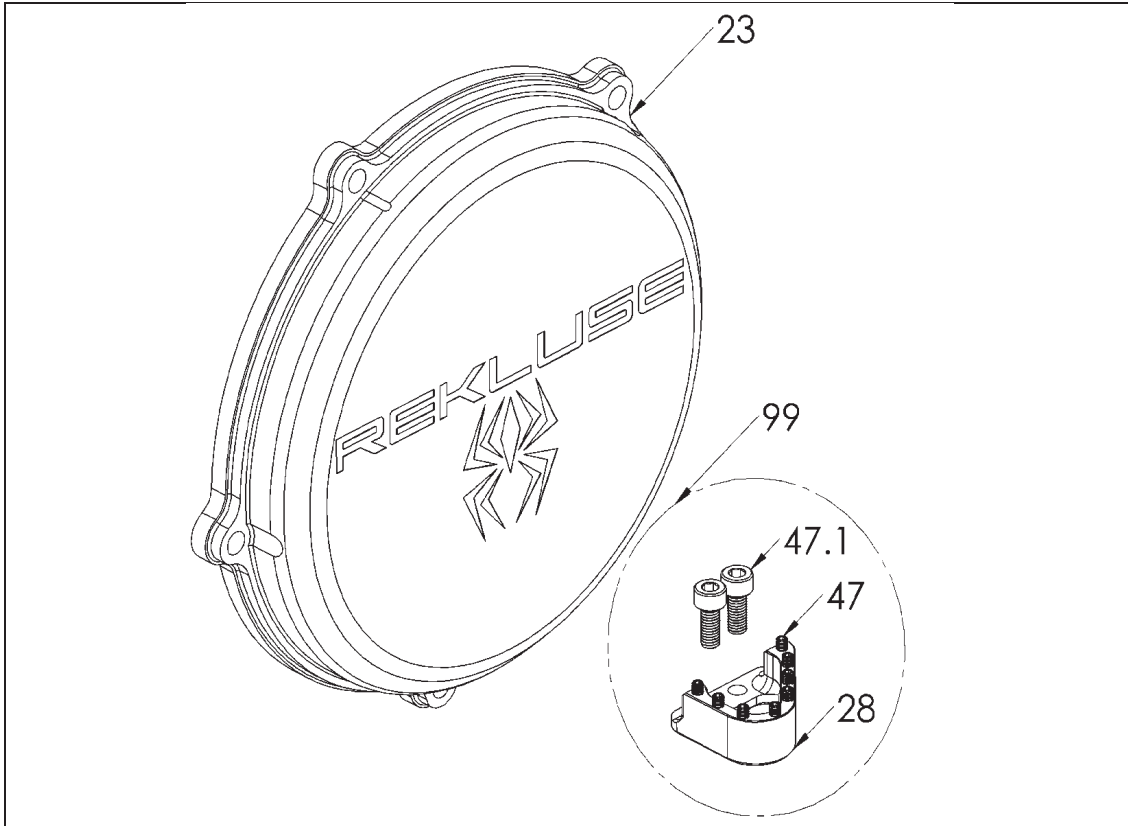

Item	Description	Qty.
23	Clutch Cover	1
99	Brake Tip Assembly	1
28	Brake Tip, Billet Piece	1
47	Set Screw - M3 x 12 Stainless (brake tip stud)	8
47.1	Screw - M5 x 12 Socket Head Zinc	2

Visit www.rekluse.com/support for a full parts fiche illustration and part numbers.

REMOVAL

1. Use a 4mm hex key to remove the OE brake tip from the brake pedal, then set it aside. The two screws can be discarded, as new screws are included in your kit.



2. Using an 8 mm socket, remove the OE clutch cover. Pay close attention to the length and location of the OE screws so that they can each be returned to the same location.
3. Inspect the condition of the OE clutch cover gasket, and replace if necessary.

INSTALLATION

1. With a good-condition gasket installed, place the Rekluse clutch cover onto the bike, then reinstall the OE bolts into the same hole locations from where they were removed.

⚠ CAUTION

Failure to install the OE clutch cover bolts back in their proper locations can result in damage to your motorcycle.

2. Install the Rekluse brake tip assembly.

a. Apply blue Loctite® 243, or thread-locking compound of similar strength, to the provided M5 screws. Install the Rekluse brake tip onto the brake pedal.

b. Torque the M5 screws to 6 ft-lb (8 N-m).

c. Readjust the brake pedal angle if necessary.

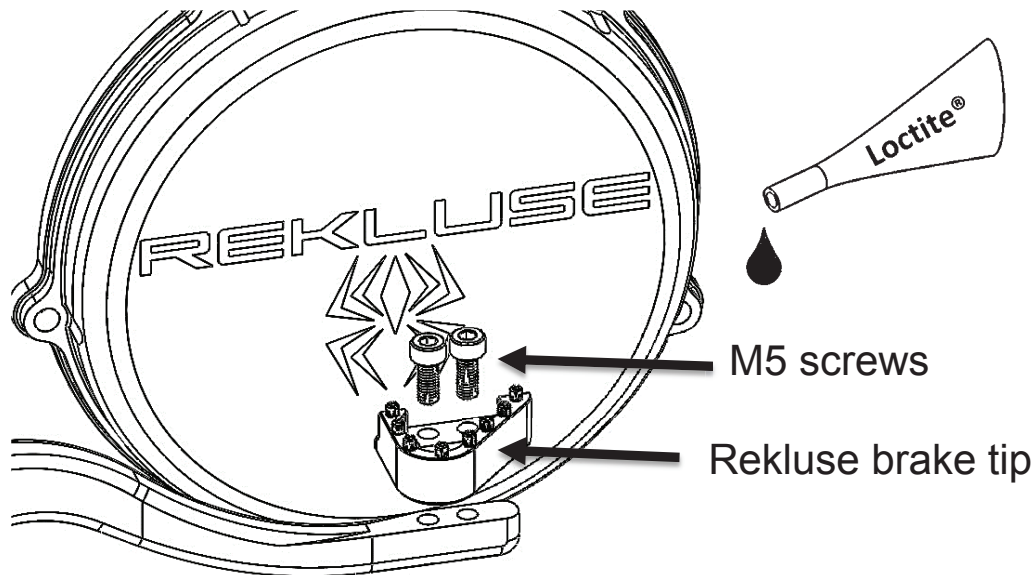

MAINTENANCE

- To keep your components functioning at their best, perform regular maintenance checks of the fasteners. Make sure all bolts and screws remain tight.
- Periodically check for signs of wear and replace components as necessary. Replacement set screws (brake tip studs) are available for purchase separately.

NEED ADDITIONAL HELP?

Website

www.rekluse.com/support

Frequently Asked Questions

www.rekluse.com/faq

Support Videos

www.rekluse.com/support/videos

Phone

(208) 426-0659

Technical Support

Contact Technical Support for questions related to product installation, tuning, and performance.

Technical Support hours:

Monday thru Friday: 8:00 a.m. - 5:00 p.m.

Mountain Time zone

Email: tech@rekluse.com

Customer Service

Contact Customer Service for additional product information, orders, and returns.

Customer Service hours:

Monday thru Friday: 8:00 a.m. - 5:00 p.m.

Mountain Time zone

Email: customerservice@rekluse.com

