

RMS-7102022A - CORE MANUAL TORQ-DRIVE CLUTCH

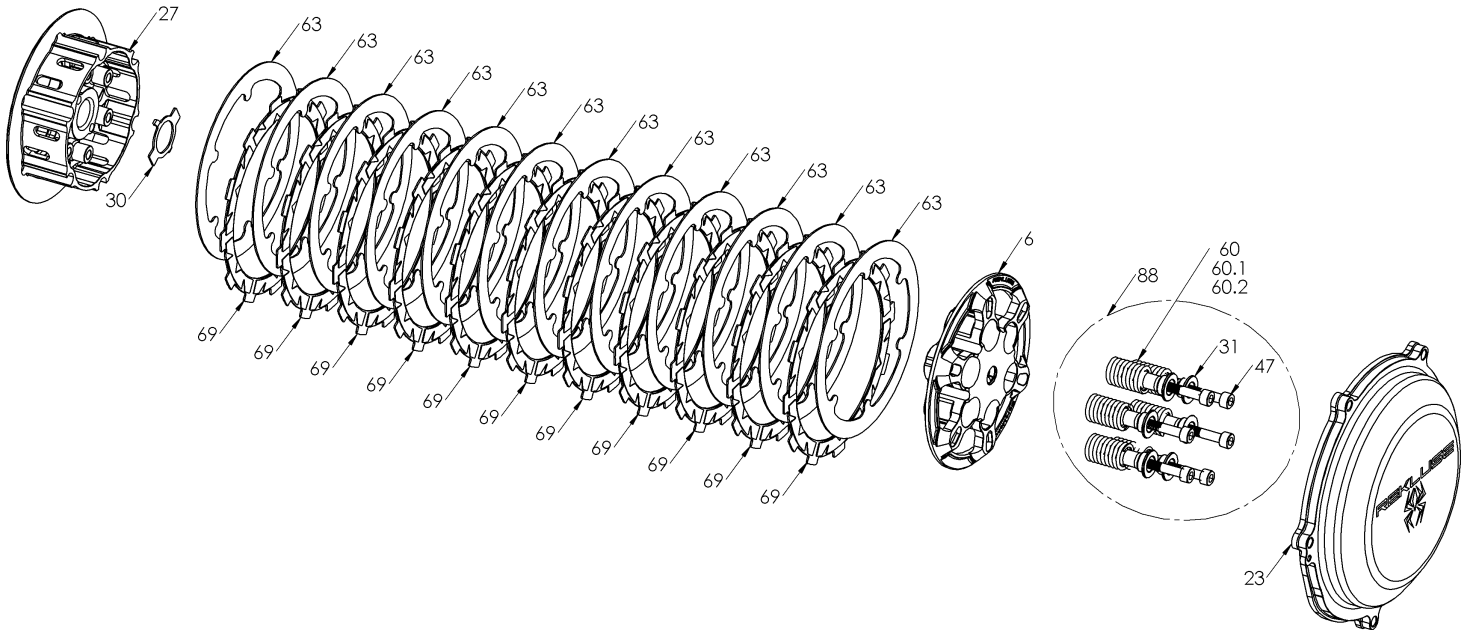

Item	Part Number	Item Description	Qty
6	114-220A	PRESSURE PLATE - CoreManual and TorqDrive - B450	1
23	169-922A	CLUTCH COVER - Beta 2T (18)	1
27	178-120A	CENTER CLUTCH HUB - RadiusCX/Core - Beta 2T & 4T (18+)	1
30	183-002	HARDWARE - Core Center Clutch Tab Lock Washer 27mm	1
63	460-621A	DRIVE PLATE - 0.040 BETA Lobed - Inverted 6-Pin	12
69	469-336A	FRICTION DISK - KT350 TORQ-DRIVE - 2-Segment Pads	11
88	744-008A	TORQ DRIVE SPRING KIT - 450 - (3 Silver, 6 Gold, 3 Red)	1
31	184-101B	HARDWARE - EXP Screw Sleeve	6
47	411-135	FASTENER - M6 x 40mm Socket Head Cap Screw	6
60	442-101	PRESSURE PLATE SPRING - 450 Class Bikes Medium Red (incl	3
60.1	442-103	PRESSURE PLATE SPRING - 250 Class Bikes Medium Silver	3
60.2	442-104	PRESSURE PLATE SPRING - 250 Class Bikes Heavy Gold	6