

# 771-7917000A - UPGRADE KIT - RADIUSX TO RADIUSCX

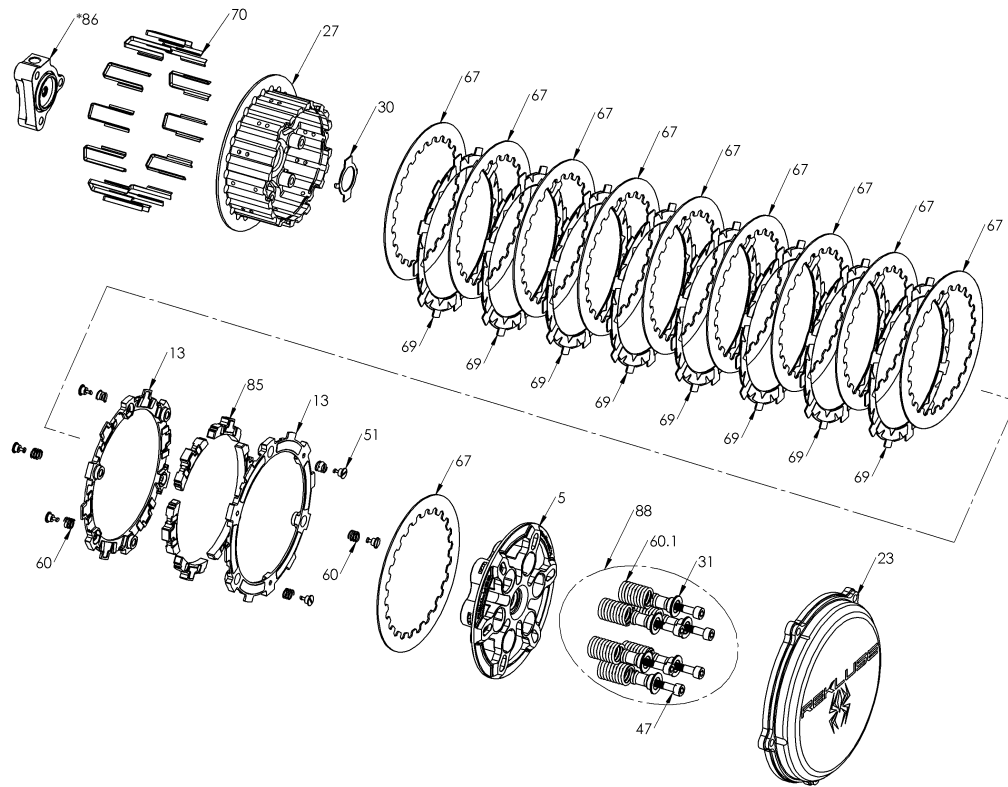

| Item      | Part Number | Item Description   | Qty |
|-----------|-------------|--|-----|
| 5         | 113-117A    | PRESSURE PLATE - RadiusCX - GasGas 250,300 2T            | 1   |
| 23        | 169-902C    | CLUTCH COVER - GAS GAS                                   | 1   |
| 27        | 178-117A    | CENTER CLUTCH HUB - RadiusCX/Core - GasGas 250,300 2T    | 1   |
| 30        | 183-004A    | HARDWARE - Core Center Clutch Tab Lock Washer 27mm S     | 1   |
| Not Shown | 418-301B    | HARDWARE - Clutch Cover O-Ring Cord-Viton - 25in long    | 1   |
| 67        | 465-416A    | DRIVE PLATE - 0.048 Core H450 GasGas                     | 10  |
| 69        | 469-331A    | FRICITION DISK - H450 TORQ-DRIVE - 2-Segment Pads        | 1   |
| 70        | 471-307A    | BASKET SLEEVE - EXP with Torqdrive                       | 12  |
| 88        | 744-010     | CORE CLUTCH SPRING KIT - 450 - Medium (Red)              | 1   |
| 31        | 184-101B    | HARDWARE - EXP Screw Sleeve                              | 6   |
| 47        | 411-135     | FASTENER - M6 x 40mm Socket Head Cap Screw               | 6   |
| 60        | 442-101     | PRESSURE PLATE SPRING - 450 Class Bikes Medium Red (incl | 6   |